

# IELTS

# LISTENING

Actual Tests With Answers



EBOOK



AUDIOS



TAPESCRIPTS

February - March 2023

TARGET SERIES



IELTSMaterial.com



**Published by**  
**IELTSMaterial.com**

This publication is in copyright. All rights are reserved, including resale rights. This e-book is sold subject to the condition that no part of this e-book may also be copied, duplicated, stored, distributed, reproduced or transmitted for any purpose in any form or by any means, electronic or mechanical, or by any information storage and retrieval system without written permission from the author.

## Preface

As far as you know, IELTS candidates will have only 30 minutes in PBT, extra 10 minutes for transferring the answers to the answer sheet for the IELTS Listening test. There will be a total of 40 questions. Therefore, it is absolutely necessary that you invest time in practicing the real IELTS Listening tests for this module.

Besides the Cambridge IELTS Practice Tests series published by Oxford University Press, IELTS Listening Recent Actual Tests with Answers aims to develop both test-taking skills and language proficiency to help you achieve a high IELTS Listening score. It contains IELTS Listening Tests in the chronological order starting from the recent tests and an Answer Key. Each test contains three Listening passages which cover a rich variety of topics and give a lot of practice for a wide range of question types used in the IELTS Exam such as multiple-choice questions, short-answer questions, sentence completion, summary completion, classification, matching lists, phrases, matching paragraph headings, identification of information – True/False/Not Given, etc. When studying IELTS with this e-book, you can evaluate at the nearest possibility how difficult the IELTS Listening Section is in the real exam, and what the top most common traps are. Moreover, these tests are extracted from authentic IELTS bank sources; therefore, you are in all probability to take these tests in your real examinations.

The authors are convinced that you will find IELTS Listening Recent Actual Tests extremely helpful on your path to success with the International English Language Testing System. Don't just trust luck in your IELTS exam – the key is practice!

**IELTS Material:** <https://ieltsmaterial.com/> | [admin@ieltsmaterial.com](mailto:admin@ieltsmaterial.com)

# Table of Contents

<b>Introduction to IELTS Listening</b>	<b>1</b>
<b>Practice Test 1</b>	<b>9</b>
Part 1	9
Part 2	12
Part 3	15
Part 4	17
<b>Practice Test 2</b>	<b>19</b>
Part 1	19
Part 2	21
Part 3	23
Part 4	25
<b>Practice Test 3</b>	<b>27</b>
Part 1	27
Part 2	29
Part 3	31
Part 4	33
<b>Practice Test 4</b>	<b>36</b>
Part 1	36
Part 2	38
Part 3	40
Part 4	42
<b>Practice Test 5</b>	<b>43</b>
Part 1	43
Part 2	46
Part 3	48
Part 4	51

<b>Practice Test 6</b>	<b>53</b>
Part 1	53
Part 2	55
Part 3	57
Part 4	59
<b>Practice Test 7</b>	<b>60</b>
Part 1	60
Part 2	62
Part 3	64
Part 4	66
<b>Practice Test 8</b>	<b>68</b>
Part 1	68
Part 2	71
Part 3	73
Part 4	76
<b>Practice Test 9</b>	<b>79</b>
Part 1	79
Part 2	81
Part 3	83
Part 4	85
<b>Practice Test 10</b>	<b>87</b>
Part 1	87
Part 2	90
Part 3	91
Part 4	94
<b>Practice Test 11</b>	<b>96</b>
Part 1	96
Part 2	98

Part 3	101
Part 4	103
<b>Practice Test 12</b>	<b>105</b>
Part 1	105
Part 2	107
Part 3	108
Part 4	110
<b>Answer Keys</b>	<b>111</b>
Listening Test 1	111
Listening Test 2	112
Listening Test 3	114
Listening Test 4	115
Listening Test 5	118
Listening Test 6	120
Listening Test 7	121
Listening Test 8	123
Listening Test 9	124
Listening Test 10	126
Listening Test 11	128
Listening Test 12	129

**Use this QR Code to Access the Audio**



**Use this QR Code to Access The Transcripts**



## PR

1. Qualification / Education Assessment
2. Customized Document Checklist and Critical Document Templates  
(Reference Letter Templates, Self Declaration templates)
3. Filing of an online application form to create a profile for an invitation and  
Complete express entry profile management
4. CRS score improvement guidance
5. Work experience document management, so you don't face technical rejection
6. Medical Exam documents and Police Clearance certificates
7. Financial and Visa document management and processing for final PR visa



## Job Search Assistance

1. Revamping your resume to international standards
2. LinkedIn profile optimization
3. Marketing your profile to the directory of employers and recruitment consultants

## IELTS Classes

1. **DIAGNOSTIC TEST** - A mock IELTS test to identify the learner's strengths and weaknesses.
2. **FREE TRIAL CLASS** - Feedback on the diagnostic test with tips and strategies to tackle weaknesses.
3. **CONCEPT BUILDING** - A customized study plan that demonstrates IELTS techniques, strategies and tricks.
4. **MOCK & PRACTICE TESTS** - Regular practice assignments and mock tests to monitor the progress of learners.
5. **ACHIEVE DESIRED SCORE** - Our trainers ensure that you achieve your desired IELTS band score.

Helpline Number: **+91 8929053019**

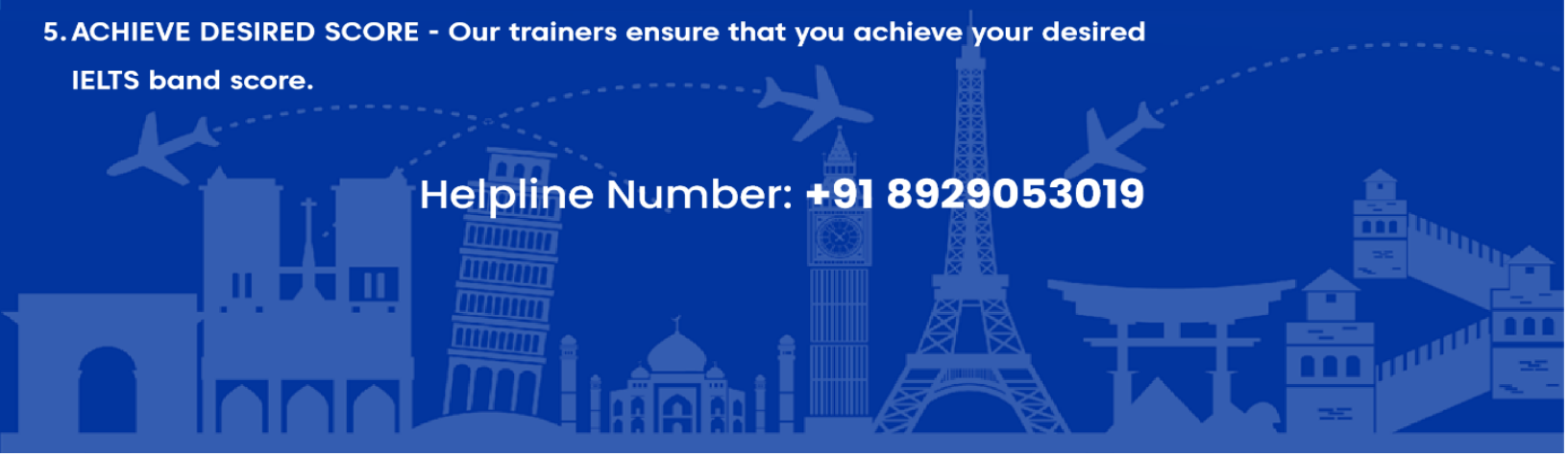



# PTE

When preparing for the Pearson Test of English (PTE) seems like a hurdle, seeking undivided guidance from perfectionists and professionals in this stream can help you significantly. So, if you're preparing for PTE, IELTSMaterial.com can come to your rescue.

## Features that make us the best:

### → 1:1 Live Learning Classes

To help you achieve the maximum score from the comfort of your home, we provide 1:1 Live Learning Classes with customized lessons.

### → Certified Trainers

IELTSMaterial is backed by a team of certified, experienced, and ingenious trainers. Our team has taken the PTE exams and cracked them with satisfactory results. Thus, you can always rely upon them when it comes to professional guidance.



## Business Communication Master Program

★★★★★ 4.8 stars of 3452 reviews



**Course Designed by**  
IIT/IIM Alumni



**MasterClass by Industry**  
Experts from Google/Microsoft

- 100+ Hrs of personal english training
- Interview readiness and CV booster
- Professional speaking and writing skills
- Advance email communication
- Master business tools like Excel, Trello etc
- Corporate communication and presenter skills



## Introduction to IELTS Listening

The IELTS listening test is the same for both those taking the Academic and General Training papers. There are four parts in the listening test. Each part has 10 questions, making a total of 40 questions. The parts become progressively harder. The answers to the questions come in the same order as the information on the recording. The whole test lasts about 30 minutes, including the instructions, your reading and listening time, and the time allowed for transferring your answers from the questions paper to an answer sheet.

### How are IELTS Listening answers scored?

A human examiner marks your answers. You get one point for each correct answer, giving you a 'raw score' out of 40. This is converted into a 'band score' from 0 to 9. For example, you need 30 correct answers to get a band score of 7.0. Even though IELTS test materials are trialed and pre-tested before being used in actual tests, there are variations in the tests' varying degrees of difficulty.

In order to combine results from several test versions, the band score limits are defined. This ensures that all test takers' outcomes are related to the same achievement scale. In plain language, this indicates that the limit for Band 6, for instance, may be set at various raw score thresholds throughout multiple versions.

Band Score Threshold	Basic Score Out of 40
8	35
7	30
6	23
5	16

## Study Guide

Here are three techniques that you can follow during your attempt for the IELTS listening test.

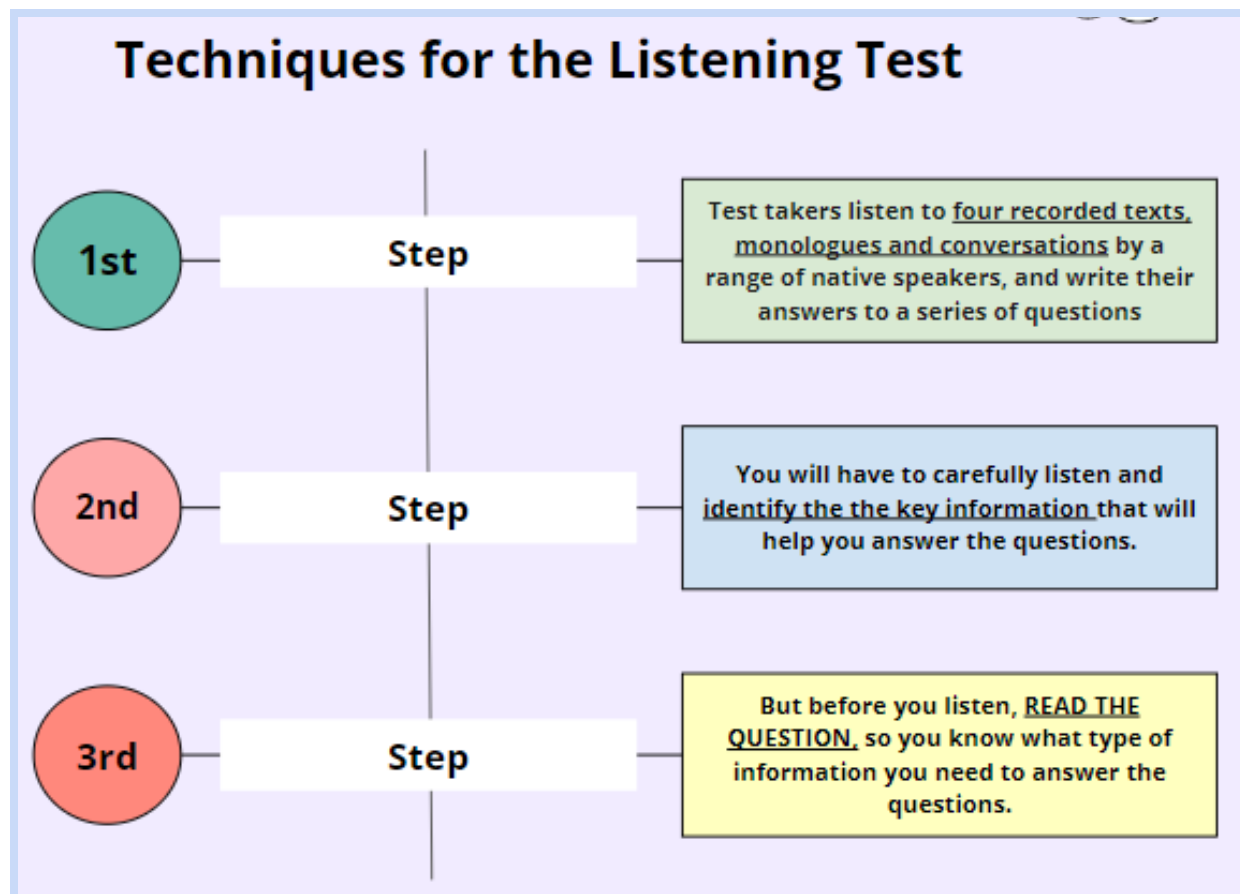



## Characteristics of Good Listening

Band	Description
9	Has fully operational command of the language: appropriate, accurate and fluent with complete understanding.
8	Has fully operational command of the language with only occasional unsystematic inaccuracies and inappropriacies. Misunderstandings may occur in unfamiliar situations. Handles complex detailed argumentation well.
7	Has operational command of the language, though with occasional inaccuracies, inappropriacies and misunderstandings in some situations. Generally handles complex language well and understands detailed reasoning.
6	Has generally effective command of the language despite some inaccuracies, inappropriacies and misunderstandings. Can use and understand fairly complex language, particularly in familiar situations.

## Tips and Tricks for different question types

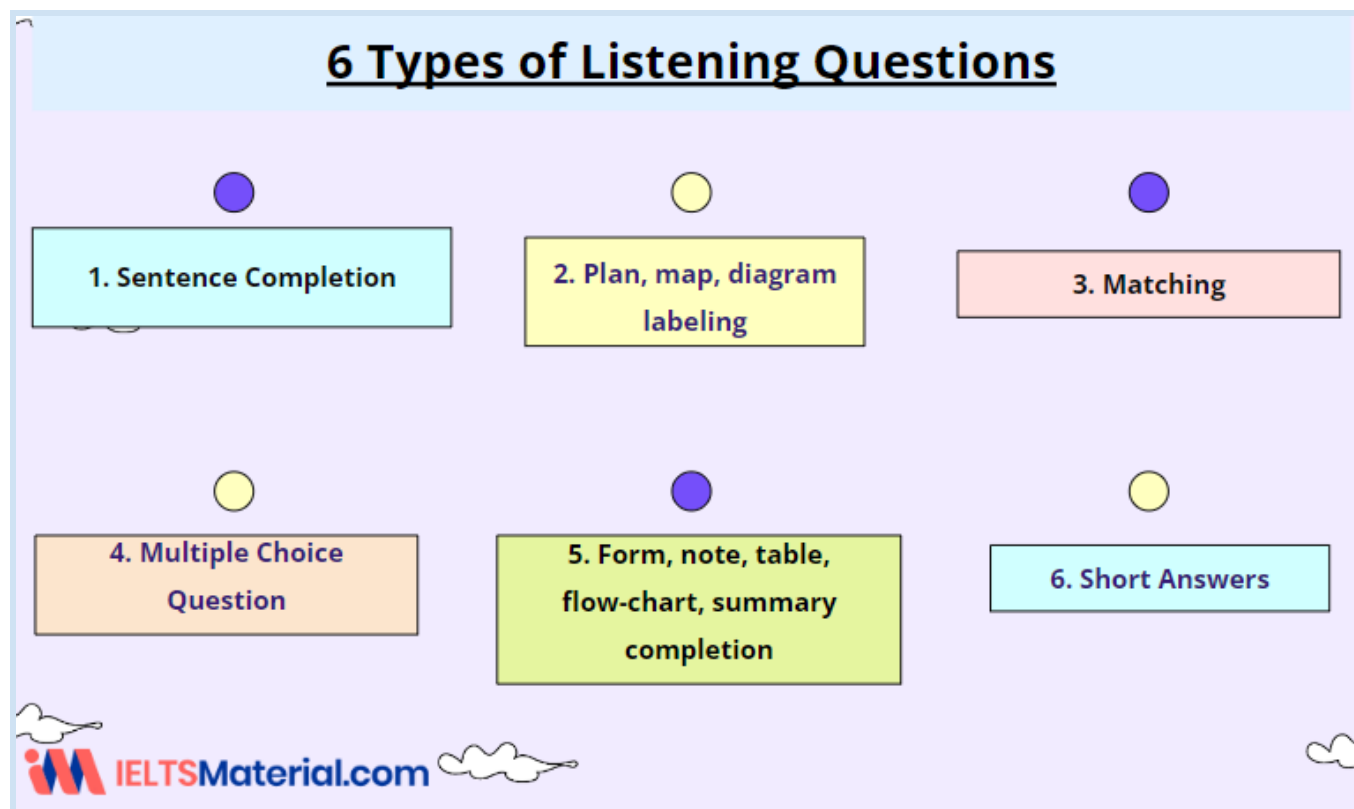

Let's look at the tips and tricks required to answer each question type:

### Multiple Choice Questions

While listening to the audio recording there will be a section for multiple-choice questions. The multiple-choice questions are of two types –

- Multiple choice questions with one answer.
- Multiple choice question with two or more answers

There are questions that have one or more answers, for those types of questions, you would have to listen keenly to identify all the answers from the options given.

There are a few things you would have to keep in mind while you're answering multiple-choice questions:

- You will hear all the options that are given to you in the question. You would have to listen to the audio and interpret the answer from what is asked in the question.
- Sometimes, the answer options might be of the same kind to confuse you. For instance, it might all be in the form of dates 15 November, 17 November or 18 November. You would have to read the question and choose the correct answer.
- The words used in the question might not be the exact words that you hear in the audio recording. So, you'd have to pay attention to synonyms and how the words are paraphrased.
- The information provided in the audio recording might not be in the same order as the questions asked, so in order to answer the questions correctly, you should have read the questions beforehand to be aware of what is being asked.
- There would be a lot of distractors in the audio recording. There would be a lot of the same kind of information. Sometimes, the speaker might give us any information and then change it, which might be the correct answer. So, do not rush and write down the answer as soon as you hear it.



## Map/ Plan/ Diagram Labeling questions

For these types of questions, you would be provided with a map and you would have to label the places on the map.

There are two types of questions:

1. A list of words might be given to you and you'd have to listen to the recording and choose the correct word that fits the blank on the map.
2. There won't be a list, you would just listen to the audio and identify the place on the map.

There are a few things you would have to keep in mind while you're answering Map Labeling questions:

- There would be directions to a place or some kind of tour.
- Read the instructions before you begin, so that you'll know the word limit of the blanks.
- Description of the location – listen to words that best describe the location given. For example, below the park, next to the supermarket, etc.
- Look at the question numbers – Look at the question numbers and identify the flow of the map. That would help you listen to what's coming next.
- The audio recording would provide you with an understanding of where you are or where you have to begin. Pay attention to it at the beginning of the recording. Also, listen to nearby places and clues to help find the answers.

## **Sentence/Summary Completion/ Note completion/ Table completion/ Diagram completion questions**

In some of the questions, there will be a gap left in between and the examiner asks you to fill that gap. In order to guess the word correctly, you must have solid grammar skills.

There are a few things you would have to keep in mind while you're answering sentence and other completion questions:

- Read the question before you start in order to understand what you should be listening for.
- Try to guess what would come in the blank. It could be a place, a number, year, name or even a specific range of information such as seasons, climatic conditions
- The words in the question need not necessarily be the same words you hear in the audio recordings, learn to tune yourself to synonyms of the words in the question.
- Though the questions might be phrased differently from the recordings, the answers should be the exact words you hear in the audio.
- Remember to check the word count, spelling and grammar before you transfer your answers to the answer sheet.

## **Matching Questions**

These questions are not as common as the other question types but they do occur in the Listening section. These questions have a list of statements that you'd have to match with the options provided. Mostly it would be names, places or dates.

There are a few things you would have to keep in mind while you're answering Match questions:

- Look at the statements and listen keenly to the kind of information that has been provided as options. i.e if the options are dates, listen keenly to all the dates in the audio.
- By the way, write down all the information linked to that particular option, it would make it easier for you to find the answer.

## Short Answer Questions

The Short answer questions require candidates to read a question and write a short answer using the information from the audio. In this question type, commonly, distractors are used. A distractor is something that appears when you get wrong information. Thus, you must listen to the recording carefully and give correct answers.

There are a few strategies that have to be borne in mind while answering these types of questions. They are listed below:

- Before you listen to the given prompt, take your time to read the question and possible answers given in the options to understand the keywords and the topic.
- Once done, underline all of the keywords. Generally, avoid underlining basic adjectives, pronouns and adverbs.
- Pay special attention to question words. These will help you find answers easily.
- Now, you can begin listening. As you listen, write out all of the information so that you will remember it afterward.
- Make sure your answer is accurate.



## What is a signposting language?

Signposting means using phrases and words to guide the reader through the content of a passage or a recording. In this case, it's an audio recording. With the help of these phrases and words, the listener can anticipate what's next and find the answer.

### Signposting Examples:

Purpose	Signposting language
Introduction to the lesson/lecture	<ul style="list-style-type: none"> <li>• The purpose of today's lecture is...</li> <li>• The subject/topic of my talk is ...</li> <li>• The lecture will outline ...</li> <li>• The talk will focus on ...</li> <li>• Today I'll be talking about / discussing...</li> <li>• Today we are going to talk about...</li> <li>• The topic of today's lecture is</li> </ul>
Describing the structure of the lecture	<ul style="list-style-type: none"> <li>• I'm going to divide this talk into a few parts.</li> <li>• First, we'll look at..... Then we'll go on to ... And finally I'll...</li> </ul>

Introducing the topic/ first point / first section	<ul style="list-style-type: none"> <li>• Let's start by talking about...</li> <li>• To begin,...</li> <li>• Firstly,...</li> </ul>
Starting an idea or linking to another idea	<ul style="list-style-type: none"> <li>• Let's move on to...</li> <li>• Now, let's turn to...</li> <li>• And I'd now like to talk about...</li> <li>• Building on from the idea that ...,</li> <li>• Another line of thought on ... demonstrates that ...</li> <li>• Having established ...,</li> </ul>
To reach the end of the talk / Summing up	<ul style="list-style-type: none"> <li>• In conclusion, ...</li> <li>• From the above, it is clear that</li> <li>• Several conclusions emerge from this analysis ...</li> <li>• To summarize, ...</li> <li>• I'd like now to recap</li> </ul>

## Practice Test 1

### Instructions to follow

- Listen to the [audio](#) and answer the questions below.

### Part 1

#### Questions 1–6

- Complete the notes below.
- Write NO MORE THAN ONE WORD AND/OR A NUMBER for each answer.



### Small claims tribunal – Claim form

IELTSMaterial.com

Claimant's name: Emily-Jane Appleby

Address: 1, Yeronga Street, (1) \_\_\_\_\_

Postcode: 4105

Telephone No. (Work) : N/A

(home): (2) \_\_\_\_\_

Respondent: (3) \_\_\_\_\_

Trading name: ABC appliances ltd

Address: (4) \_\_\_\_\_ avenue, Bardon

Postcode: (5) \_\_\_\_\_



Telephone no. (work): 72324681

Date (of transaction): 3/2/2011

Warranty/Guarantee: (6) \_\_\_\_\_

### Questions 7-10

#### Instructions to follow:

- Complete the notes below.
- Write NO MORE THAN TWO WORDS AND/ OR A NUMBER for each answer.

#### Full particulars of claim

Good: (7) \_\_\_\_\_ – ('Mallard' brand,

'Whisper'

model, serial no. XY303)

Agreed to pay: (8) \_\_\_\_\_ £

Good delivered on: 5/3/2011

ABC appliances picked up the trade in on the same date.

Salesman said: Mallard Whisper model

- Uses less energy because it has shorter cycle
- Reduces the amount of (9) \_\_\_\_\_ used

- Whisper quiet

Complaint: the cycle is longer and the appliance is very

(10) \_\_\_\_\_

**Student Space:**

 IELTSMaterial.com

## Part 2

### Questions 11–14

#### Instructions to follow

- Choose the correct letter A, B or C.

11. Jack says that in London these days many people

- A. see cycling as a foolish activity
- B. have on experience of cycling
- C. take too many risks when cycling

12. If people want to cycle to school or work, CitiCyclist helps them by

- A. giving cycling lessons on the route they take.
- B. advising them on the safest route to choose.
- C. teaching them basic skills on quiet roads first

13. Jack works with some advanced cyclists who want to develop

- A. international competitive riding skills.
- B. knowledge of advanced equipment.
- C. confidence in complex road systems.

14. CitiCyclist supports the view that cyclists should

- A. have separate sections of the road from motor traffic.
- B. always wear protective clothing when cycling.
- C. know how to ride confidently on busy roads.

**Questions 15–17**

**Instructions to follow**

- Choose **THREE** types of organizations for which CitiCyclist provides services.

- A training courses
- B schools
- C local councils
- D individuals
- E companies

15. \_\_\_\_\_

16. \_\_\_\_\_

17. \_\_\_\_\_

**Questions 18–20****Instructions to follow**

- **Complete the notes below. Write NO MORE THAN THREE WORDS AND OR A NUMBER for each answer.**

Website address:      citicyclist.co.uk

Phone:                      (18) \_\_\_\_\_

Cost (single person):    (19) \_\_\_\_\_ per person

Usual length of course: (20) \_\_\_\_\_ except complete  
beginners)

**Student Space:**



## Part 3

### Questions 21–24

#### Instructions to follow

- Complete the table showing the modules Zeo is taking or considering taking this semester.

A = Accountancy

B = Banking and Finance

E = Economic

I = Introduction to Economics

P = Principles of Financial Accounting

= Principles of Marketing

21. ....

22. ....

23. ....

24. ....

### Questions 25–28

#### Instructions to follow

- Complete the information below.
- Write ONE WORD ONLY for each answer.

25. Zeo is worried about doing a type of mathematics called ..... .

26. Her adviser recommends she do a brush-up ..... .
27. Zeo needs to develop the reading skills of skimming and ..... .
28. The course develops these skills through a series of specially-designed ..... .

### Questions 29–30

#### Instructions to follow

- Choose the correct letters, A to D.

29. Zeo's adviser recommends she learn the ..... .

- A. Academic Vocabulary List
- B. The Academic Word List
- C. The General Word List
- D. Academic Resource Li

30. The list contains ..... .

- A. 517 words
- B. 970 collocations
- C. 570 word families
- D. 2000 words

## Part 4

Questions 31–36

### Instructions to follow

- Write **ONE WORD ONLY** for each answer.

(31) \_\_\_\_\_ a currency

Imagine you need to (32) \_\_\_\_\_ 100 pounds.

(33) \_\_\_\_\_ facts about the state of your country's economy

Look at other other students' notes on their countries

Decide what your exchange 'rate' is going to be against each currency

Try to (35) \_\_\_\_\_ your currency

(36) \_\_\_\_\_ other currency if you want

(37) \_\_\_\_\_ your profit

**Questions 37–40****Instructions to follow**

- **Answer the questions below.**
- **Write NO MORE THAN TWO WORDS AND/OR A NUMBER for each answer.**

**37.** How many main trading partners does the UK have? \_\_\_\_\_

**38.** Which sector does the tutor want students to study? \_\_\_\_\_

**39.** What does the tutor want students to look at? \_\_\_\_\_

**40.** When does the tutor want the project completed? \_\_\_\_\_

**Student Space:**

IELTSMaterial.com

## Practice Test 2

### Instructions to follow

- Listen to the [audio](#) and answer the questions below.

### Part 1

#### Questions 1–4

- Complete the notes below.
- Write NO MORE THAN ONE WORD AND/OR A NUMBER for each answer.

### Notes for Holiday



#### Travel Information:

- Must find out which (1) \_\_\_\_\_ arriving at.
- Best Taxi company (2) \_\_\_\_\_
- Note: Simon lives in the (3) \_\_\_\_\_ of the city
- Simon's cell phone number: (4) \_\_\_\_\_



**Questions 5 – 10****Instructions to follow**

- **Complete the notes below.**
- **Write NO MORE THAN TWO WORDS AND/OR A NUMBER for each answer.**

**What to pack****To wear:**

- casual clothes
- one smart dress to wear at a (5) \_\_\_\_\_.
- a good (6) \_\_\_\_\_.
- tough (7) \_\_\_\_\_.

**To read:**

- try to find book named (8) \_\_\_\_\_ by Rex Campbell

**For Presents:**

- For Janice: (9) \_\_\_\_\_.
- For Alec: (10) \_\_\_\_\_ (with racing pictures).

## Part 2

### Questions 11–14

#### Instructions to follow

- Complete the form below.
- Write **NO MORE THAN THREE WORDS AND/OR A NUMBER** for each answer.

### DVD Customer Profile

Occupation: student (For example)

Have you owned a DVD player before? No

What is the maximum you want to spend on a DVD player? **(11)** \_\_\_\_\_.

How often do you watch DVDs? **(12)** \_\_\_\_\_.

What type of films do you enjoy? **(13)** \_\_\_\_\_

What other DVDs (non-film) do you watch? **(14)** \_\_\_\_\_

## Questions 15–20

## Instructions to follow

- Complete the table below.
- Write NO MORE THAN TWO WORDS AND/OR A NUMBER for each answer

Player	Features	Cost	After-sales service
DB 30	basic	£69	(15) _____ only
XL 643	Can also (16) _____	(17) _____	(18) _____ at reduced cost
TriX 24	Will also play (19) _____	£94 including (20) _____	Guaranteed for 3 years

## Part 3

### Questions 21–26

#### Instructions to follow

- Complete the table showing the student's opinion
- Choose your answers from the box below
- There are more words than spaces so you will not use them all.
- You may use any of the words more than once.

Student	Favorite Instrument	Favorite style of music
Greg		
Alexandria		
Katja		
Rachel		
Harry		
Emika		

**Instrument**

Guitar Violin Pipa

Organ Piano Bouzouki

Piano Drums Harp

**Style of Music**

Ballet music Rap Classical

Heavy metal Opera Jazz

Rock Be-Bop Country

**Questions 27–30****Instructions to follow**

- Complete the form below.
- Write **NO MORE THAN TWO WORDS** for each answer.

27. Stimulating music speeds up our \_\_\_\_\_

28. Calming music reduces our \_\_\_\_\_.

29. \_\_\_\_\_ music has very predictable rhythms.

30. Research may show if people of different \_\_\_\_\_ perceive music differently.



## Part 4

### Questions 31–33

#### Instructions to follow

- Choose the correct answer, A, B or C.

31. 'Extremophiles' are life forms that can live in
- A. isolated areas.
  - B. hostile conditions.
  - C. new habitats.
32. The researchers think that some of the organisms they found in Antarctica are
- A. new species.
  - B. ancient colonies.
  - C. types of insects.
33. The researchers were the first people to find life forms in Antarctica
- A. in the soil.
  - B. under the rock surface.
  - C. on the rocks.

**Questions 34–40****Instructions to follow**

- **Complete the sentences below.**
- **Write ONE WORD ONLY for each answer.**

**How the extremophiles survive?**

34. Access to the sun's heat can create a \_\_\_\_\_ for some organisms.
35. The deeper the soil, the higher the \_\_\_\_\_ of salt.
36. Salt can protect organisms against the effects of \_\_\_\_\_ even at very low temperatures.
37. All living things must have access to \_\_\_\_\_ water.
38. Salt plays a part in the process of \_\_\_\_\_ which prevents freezing.
39. The environment of \_\_\_\_\_ is similar to the dry valleys of Antarctica.
40. This research may provide evidence of the existence of extra terrestrial life forms and their possible \_\_\_\_\_ on other planets.

## Practice Test 3

### Instructions to follow

- Listen to the [audio](#) and answer the questions below.

### Part 1

#### Questions 1–10

- Complete the notes below.
- Write NO MORE THAN ONE WORD AND/OR A NUMBER for each answer.

### Goodbye party for John

Venue:	College Dining room
Invitations (Tony) Who to invite:	<ul style="list-style-type: none"> <li>- John and his (1) .....</li> <li>- Director</li> <li>- the office (2).....</li> <li>- all the teachers</li> <li>- all the (3).....</li> </ul>
Date for sending invitations:  Present (Lisa)	<ul style="list-style-type: none"> <li>- (4).....</li> </ul>
Collect money:	<ul style="list-style-type: none"> <li>- coffee breaks</li> <li>- \$ (5).....</li> </ul>

Check prices for:	<ul style="list-style-type: none"> <li>- CD players</li> <li>- set of (6).....</li> <li>- coffee (7).....</li> </ul>
Ask guests to bring:	<ul style="list-style-type: none"> <li>- snacks</li> <li>- music (8).....</li> <li>- (9).....</li> </ul>
Ask students to prepare a	<ul style="list-style-type: none"> <li>- (10).....</li> </ul>

**Student Space:**

## Part 2

### Questions 11 – 15

#### Instructions to follow

- Choose the correct letters A – C.

11. To find out how much holidays cost, you should press button

- A. one
- B. two
- C. three

12. Travelite currently offer walking holidays

- A. only in Western Europe
- B. all over Europe
- C. Outside Europe

13. The walks offered by Travelite

- A. cater for a range of walking abilities
- B. are planned by guides from the local area
- C. are for people with good fitness levels

14. On travelite holidays people holidaying alone pay

- A. the same as other clients
- B. only a little more than other clients
- C. extra only if they stay in a large room.

**15. Entertainment is provided**

- A. When guests request it**
- B. most nights**
- C. every night**

**Questions 16 – 20**

**Instructions to follow**

- **Complete the table below.**
- **Write NO MORE THAN TWO WORDS OR A NUMBER in each gap.**

<b>Length of holiday</b>	<b>Cost per person (including all accommodation costs)</b>	<b>Special offers included in price</b>
3 days	\$ (16) _____	Pick up from the (17) _____
7 days	\$350	As above plus: <ul style="list-style-type: none"> <li>• book of (18) _____</li> <li>• Maps</li> </ul>
14 days	\$ (19) _____	As above plus membership of a (20) _____



## Part 3

### Questions 21 – 26

#### Instructions to follow

- Complete the table below
- Write NO MORE THAN ONE WORD AND/OR A NUMBER in each gap.

Experiment number	Experiment	Purpose
Experiment 1	(21) _____ And a table	To show how things move on a cushion of air
Experiment 2	Lots of paperclips	To show why we need a standard unit of (22) _____.
Experiment 3	(23) _____ Salt and jar of water	To show how (24) _____ grow
Experiment 4	Cardboard, colored pens and a (25) _____	To teach children about how (26) _____ is made up
Experiment 5	A drill, an old record, a needle, paper, a bolt	To make a record player in order to learn about recording sound

## Questions 27 – 30

### Instructions to follow

- Match your answers A – H from the box next to questions 27 – 30.

What problems do the speakers identify for each experiment?

A. too messy	Experiment 1: (27) _____
B. too boring	
C. too difficult	Experiment 2: (22) _____
D. too much equipment	
E. too long	Experiment 3: (23) _____
F. too easy	
G. too noisy	Experiment 4: F
H. too dangerous	Experiment 5: (24) _____

## Part 4

### Questions 31 – 34

#### Instructions to follow

- Complete the note below
- Write **NO MORE THAN ONE WORD AND/OR A NUMBER** in each gap.

### Shark in Australia

Length:	largest caught	16 metres
Weight:	Heaviest	(31) _____ kg
Skeleton:	Cartilage	
Skin texture:	Rough barbs	
Swimming aids:	fins and (32) _____	
Food:	gathered from the ocean (33) _____  Sharks locate food by using their sense of (34) _____	

**Questions 35 – 38****Instructions to follow**

- **Choose the correct letters A – C.**

**35.** Sharks meshing uses nets laid

- A.** along the coastline
- B.** At an angle to the beach
- C.** from the beach to the sea

**36.** Other places that have taken up shark meshing include

- A.** South Africa
- B.** New Zealand
- C.** Tahiti

**37.** The average number of sharks caught in nets each year is

- A.** 15
- B.** 150
- C.** 1500

**38.** Most sharks are caught in

- A.** spring
- B.** summer
- C.** winter

**Questions 39 – 40****Instructions to follow**

- Choose TWO letters A – G.

**Which TWO factors reduce the benefits of shark nets?**

- A. net wrongly positioned
- B. strong waves and currents
- C. too many fish
- D. sharks eat holes in nets
- E. moving sands
- F. nets too short
- G. holes in nets scare sharks

39. \_\_\_\_\_.

40. \_\_\_\_\_.

## Practice Test 4

### Instructions to follow

- Listen to the [audio](#) and answer the questions below.

### Part 1

#### Questions 1-3

- Complete the notes below.
- Write NO MORE THAN TWO WORDS AND/OR A NUMBER for each answer.

Customer called about television repairs

Customer's name: Mrs (1) \_\_\_\_\_

Address: 135 park (2) \_\_\_\_\_ Sommerton

Phone: (3) \_\_\_\_\_

#### Questions 4 - 7

- Answer the questions below.
- Write NO MORE THAN TWO WORDS AND/OR A NUMBER for each answer.

4. What is the problem with the TV ? \_\_\_\_\_
5. What may have caused the problem ? a \_\_\_\_\_
6. What is the TV make and model number? \_\_\_\_\_
7. How old is the TV ? \_\_\_\_\_ old

**Questions 8 – 10**

- Choose the correct letters, A, B or C.

8. Where is the customer's house ?

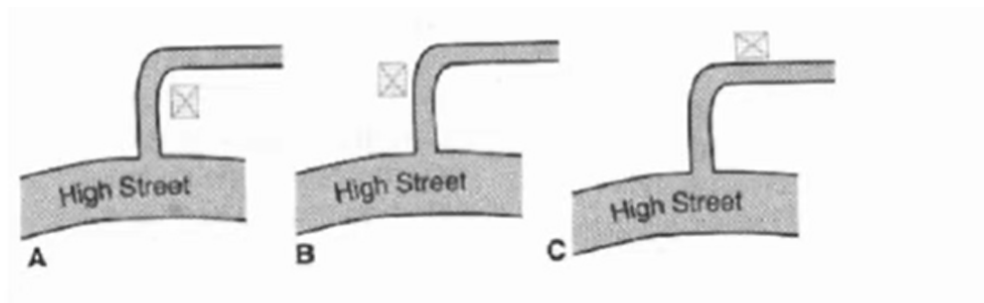

9. When will the electrician call at the house ?

- A. Friday afternoon
- B. Saturday morning
- C. Monday morning

10. Now did the customer first hear about the repair service ?

- A. from a neighbour
- B. from the phone book
- C. from the Internet

## Part 2

### Questions 11 – 16

- Choose the correct letter, A, B, or C.

11. What is the purpose of the talk?

- A. to welcome its new members
- B. to commemorate its 10th anniversary
- C. to celebrate the award it received recently

12. What's the audience of this speech?

- A. journalists
- B. local residents
- C. school children

13. Why is the speaker most proud of the skating rink?

- A. Because two world champions have been trained there.
- B. Because people in this area are fitter than the rest of the country.
- C. Because they have encouraged local school children to participate more in sports.

14.. The complex has recently opened a new venue for

- A. the unemployed.
- B. mothers with babies.
- C. pensioners



15. What does the complex plan to do next year?

- A. extend opening hours
- B. expand the space
- C. sell fitness equipment

16. What does the complex encourage people to do?

- A. become a coach
- B. be on the committee
- C. work as volunteers

### Questions 17 – 30

- Choose FOUR answers from the box and write the correct letter, A–G, next to Questions 17–20.

### Features

- A A one-on-one coach is bookable.
- B It is featured in a TV drama.
- C It is beneficial for young people.
- D It is only available for women sometimes.
- E It is the largest in the country.
- F It can be booked for parties.
- G It is a place to hold courses for school children.

### Sports facilities

- 17. Swimming pool
- 18. Climbing wall
- 19. Skating rink
- 20. Gym

## Part 3

### Questions 21 – 26

- Complete Judith's notes below.
- Write NO MORE THAN TWO WORDS for each answer.

### North Sea Oil And Gas Industry Background

- North Sea oil and gas exploration was initially rejected but has now really expanded during **(21)**.....years.
- First significant quantities of gas first discovered in Groningen area off The Netherlands in 1959.
- First British discovery of same in West Sole field, off the coast of East Anglia, by **(22)**.....in 1965.
- British oil and gas industry experienced rapid growth in the early years.
- An **(23)**.....in the UK led to enormous pressure to increase production of North Sea gas and oil.
- Oil field discoveries increased with British, European and American firms buying North Sea exploration **(24)**.....
- In 1990s the oil business suffered due to **(25)**.....of oil.
- Production grew and peaked around 2000/1.
- North Sea is currently looked upon as a **(26)**.....on a slow decline.

## Questions 27 – 30

- Complete the summary of Fred's talk below.
- Write NO MORE THAN TWO WORDS for each answer.

### North Sea Oil And Gas Industry Background

Although the Sea Gem was the first North Sea oil exploration accident, the most well known accident was aboard the Piper Alpha platform in 1988 when 13 people died. Because of these and other accidents, platforms now have rigorous safety procedures, for example:

- Installation Safety Tour showing all safety aspects eg: –  
(27).....
- emergency muster stations  
(28).....
- emergency procedures
- Rig Safety Programme Introduction
- Weekly Safety Meetings
- Daily Pre "Tour" Meetings
- Inter Company Safety Information Scheme
- Fire and Boat Practice with (29).....
- Mock Abandon the Rig Exercise

Statistics now show that these measures have succeeded and that workers are more likely to be killed on (30).....

## Part 4

### Questions 31 – 40

- Complete the notes below.
- Write ONE WORD for each answer.

### Arguments For And Against Urban Migration

#### Cities now:

- account for 3% of the planet's land areas
- consume more (31)..... than the countryside

#### Advantages for moving into the city:

- good for some (32)..... to recover
- poor (33)..... in the countryside
- clean energy: recycling of methane gas produced from (34).....

#### For women:

- more likely to have late marriages
- better chance of getting a (35)..... at work

#### Downsides of moving into the city:

- possible to lose (36)..... because it is difficult to maintain previous lifestyle
- higher rates of (37)..... in the city than in the country
- poor quality of (38)..... in the city

#### Economic factors:

- Increased (39)..... in population results in increase in energy consumption.
- People find the heavy (40) ..... stressful.

## Practice Test 5

### Instructions to follow

- Listen to the [audio](#) and answer the questions below.

### Part 1

#### Questions 1 – 5

- Complete the form below.
- Write NO MORE THAN THREE WORDS OR A NUMBER for each answer

### Cheapies Car Hire

#### Rental Form

#### Example

Date Car Needed

7th August

Customer's Name

Mr. John Wilson

Customer's Address

(1) .....

Manchester

Postcode

MW7 4DF

Home Tel.

020 6834 6387

Mobile Tel.

(2) .....

Driving License No.

(3) .....

Number of Drivers

Length of Rental

(4).....days

Car Make Chosen

(5) .....

**Questions 6 – 8**

- **Complete the Cheapies Customer Information Leaflet below.**
- **Write NO MORE THAN THREE WORDS OR SOME NUMBERS for each answer.**

**Cheapies Customer Information Leaflet**

Dear Sir/Madam

Thank you for hiring a car from Cheapies. We value your custom and we will endeavor to provide you with the service that you expect.

Total Price (6).....

Pick up point The International Hotel

Drop off point (7).....

We provide some things in the car to help you. Your sales representative will go through all the things that you will find in your glove compartment and boot. Different cars have different things provided.

In case of (8) ..... or (9) ....., call our emergency number 06387 638 972 to order a replacement car.

**Questions 9 – 10**

- **Choose and circle TWO letters A – J.**

Which TWO items are NOT provided in Mr. Wilson's hire car?

- A. insurance documents
- B. Westley town map
- C. the car manual
- D. a larger area map of the local district
- E. a map of London
- F. a spare wheel
- G. a set of tools
- H. RAC membership card
- I. a small fire extinguisher
- J. spare keys for the car

9 \_\_\_\_\_

10 \_\_\_\_\_

## Part 2

### Questions 11 – 16

- Complete the form below.
- Write NO MORE THAN TWO WORDS OR A NUMBER for each answer

### Barker's Country Safaris!

Established: (11) ..... years ago by John and Nancy Barker.

As teens the Barkers enjoyed: climbing , kayaking, white-water rafting, pot-holing (12) .....

At University they organized: motor trips (13) ..... tours

5 years ago: they (14) ..... their regular jobs  
(15) ..... years later

they began running activity tours 1 year ago started activities for (16) ..... groups



## Questions 17 – 20

- Complete the table below.
- Write NO MORE THAN TWO WORDS OR A NUMBER for each answer.

### Tour Options

Name	Size	Times
Woodland tour and trail	10 jeeps (17) ..... people per jeep	Morning: 8 am Afternoon: (18) ..... pm to 6 pm Evening: 7–11 pm
Family (19).....	1 jeep/jeeps if (20)..... party	Whole Day From 10 am till 11 pm

## Part 3

### Questions 21 – 23

- Choose THREE letters A–G.

According to the discussion, which THREE reasons are given for dividing up tasks in a group?

- A people can do whatever they want
- B the lecture notes suggested it
- C the work will be distributed evenly
- D a classmate suggested it
- E some tasks take longer
- F most groups do it this way
- G some tasks are more difficult than others

21. \_\_\_\_\_

22. \_\_\_\_\_

23. \_\_\_\_\_

## Questions 24 – 26

- Complete the table below
- Write NO MORE THAN TWO WORDS for each answer.

### Schedule Of Tasks

Person responsible	Tasks	Due date
Tom	Design the survey	March 23
Anne	(24) _____	Mid-march
Carol	(25) _____ the survey	(26) _____ late march

## Questions 27 – 30

- Complete the notes below.
- Write NO MORE THAN TWO WORDS OR A NUMBER for each answer

### Guidelines for Oral Presentation

Due date: April 12

Length: (27) \_\_\_\_\_ Minutes max \_\_\_\_\_ minutes

Points for delivery: maintain (28) \_\_\_\_\_

- don't read the presentation
- speak clearly

**Make use of gestures**

Include a variety of **(29)** \_\_\_\_\_

- OUTs
- Handouts
- use the **(30)** \_\_\_\_\_
- DVD or video

**Student Space:**



## Part 4

### Questions 31 – 35

- Complete the table below.
- Write NO MORE THAN TWO WORDS for each answer

Name of Area	Location of Area	Purpose of Area
Decompression zone (sometimes called the (31)..... zone)	situated immediately inside the entrance and is generally free of (32) .....	to encourage the customer to (33)..... to the supermarket
(34)..... zone	situated on the right side near the front door	to relax before they start shopping
power aisle	the central route through the supermarket	to display (35).....

**Questions 36 – 40**

- **Choose letters A-E and answer Questions 36 – 40.**

Which items do the following sentences apply to?

- A** fruit and vegetables
- B** bread and milk
- C** cheap tinned foods
- D** flowers
- E** sunglasses

**36.** They are referred to as distress goods. ....

**37.** They are always located at the front of the supermarket. ....

**38.** They are referred to as destination goods. ....

**39.** They are normally located below eye level. ....

**40.** They are often located at the check-out. ....

## Practice Test 6

### Instructions to follow

- Listen to the [audio](#) and answer the questions below.

### Part 1

#### Questions 1–6

- Complete the notes below. Write ONE WORD ONLY for each answer.

### The Most of Graduate School

1. First, students should pay more attention to the relationship with their \_\_\_\_\_.
2. Students should meet their tutor \_\_\_\_\_.
3. Add a "to do" list for students themselves and the tutor, including a reading \_\_\_\_\_.
4. Students should \_\_\_\_\_ with their tutor, if they disagree with their advisor, they must state their 5 \_\_\_\_\_ and 6 \_\_\_\_\_ clearly and calmly.

**Questions 7 - 10**

- **Look at the checklist below. Select A-G and answer questions 7-10**

The principles for the students about getting the most out of what they read

- A.** be organised
- B.** keep your "to do" list
- C.** be efficient
- D.** write the time and date of next meeting
- E.** summarise what you have read
- F.** minimise your other commitments
- G.** read PhD theses

7 \_\_\_\_\_

8 \_\_\_\_\_

9 \_\_\_\_\_

10 \_\_\_\_\_



## Part 2

### Questions 11 – 14

- Complete the information below.
- Write NO MORE THAN TWO WORDS for each answer.

The National Union of Students will run a National **11** \_\_\_\_\_ next month. Every student should **12** \_\_\_\_\_ some time to help the community. This is a nationwide scheme. It has two aims: to show the public that students are **13** \_\_\_\_\_ members of society, to show students can give their **14** \_\_\_\_\_ help to their community.

### Questions 15 – 17

- Complete the information below.
- Write NO MORE THAN TWO WORDS for each answer.

The old man's name is **15** \_\_\_\_\_.

Address 8 Milkman **16** \_\_\_\_\_.

Students' job paint **17** \_\_\_\_\_.

**Questions 18 – 20**

- **Indicate whether the following statements are accurate or not by writing.**

**A** for an accurate statement  
**B** for an inaccurate statement  
**C** if there is insufficient information

**18.** The old lady never went out to work.

**19.** The old lady's husband once served in the Army.

**20.** The girl student also liked the book very much.

**Student Space:**

## Part 3

### Questions 21 – 24

- Indicate whether the following statements are accurate or not by writing.

### Conference Registration Form

Name of Conference: Beyond 2000

Name: Melanie Ms **21** \_\_\_\_\_

Address: Room **22** \_\_\_\_\_ at  
Women's College Newtown

Faculty: **23** \_\_\_\_\_

Student No: **24** \_\_\_\_\_

### Questions 25 – 30

- Circle the correct letters A–C.

25. Registration for:

- A. Half day
- B. Full day
- C. Full conference

26. Accommodation required:

- A. Share room/share bathroom
- B. Own room/share bathroom
- C. Own room with bathroom

**27. Meals required:**

- A. Breakfast
- B. Lunch
- C. Dinner

**28. Friday SIGs:**

- A. Computers in Education
- B. Teaching Reading
- C. The Gifted Child

**29. Saturday SIGs:**

- A. Cultural Differences
- B. Music in the Curriculum
- C. Gender Issues

**30. Method of payment:**

- A. Credit Card
- B. Cheque
- C. Cash

## Part 4

### Questions 31 – 40

- Answer the questions below.
- Write **NO MORE THAN TWO WORDS OR A NUMBER** for each answer.

31. In which decade did the British Council create the EPTB exam?
32. What did the 'B' of 'EPTB' stand for?
33. In which year was ELTS introduced?
34. What kind of language 'context' was ELTS intended to reflect?
35. How many candidates took ELTS in 1985?
36. What was conducted in 1987?
37. Of what were there 210 in 1995?
38. Which IELTS module was revised in 2001?
39. In which year was a computerised version of the exam introduced?
40. How does the lecturer describe the 'industry of English-language exams'?

## Practice Test 7

### Instructions to follow

- Listen to the [audio](#) and answer the questions below.

### Part 1

#### Questions 1-2

- Complete the notes below.
- Write ONE WORD OR A NUMBER for each answer.

1. The address of Avis: 14A ..... Road , Oxford.

2. Telephone No. for the first rent: .....

#### Questions 3-4

- Choose a letter from A-C.

3. Maxine wants to rent a

- A. luxury car
- B. compact car
- C. minivan

#### 4. The car Maxine choose features

- A. manual transmission
- B. CD stereo system
- C. cruise control

#### Questions 5-10

- **Complete the form below.**
- **Write NO MORE THAN TWO WORDS OR A NUMBER for each answer.**

Rent price: (5)..... each day.

Discounts not apply to: tax , (6)..... and (7)..... .

Rent start day: (8)..... 30th April.

Driver's license No. (9)..... .

Optional service chosen: (10)..... .

**Student Space:**

## Part 2

### Questions 11-14

- Write the appropriate letters A-G against questions 11-14.

- A** ferment and produce the alcohol
- B** may spoil beer
- C** prevent bacterial action
- D** add a sweet taste to beer
- E** add some bitter taste to beer
- F** produce dried and crushed sprouts

#### Ingredients

Malt

Small flowers of hope vines

Hops

Yeast

#### Function

11.....

12.....

13.....

14.....



**Questions 15–20**

- **Complete the information below.**
- **Write ONE WORD OR A NUMBER for each answer.**

**Facts About Beer!**

Alcoholic Percent	from 2% to (15).....
Dangers	to cause difficulties in (16)..... and think clearly
Benefits	Moderation consumption prevents heart disease. Selenium improves bone (17).....
A Common mistake	Genes but not beers decide the way how fat is (18).....
Storage	to be stored in cool and (19)..... place preferred bottle colour – (20).....

**Student Space:**

### Part 3

#### Questions 21–24

- Circle the correct letter.

**Ch** – Chairs

**Co** – Couches

**CCT** – Chairs and Couches

#### Type of seating !

21. Wilson Hall .....

22. Jones Hall .....

23. Agriculture Hall .....

24. Skid more Hall .....

#### Questions 25–30

- Circle the correct letter.

**A** – ONE

**B** – TWO

**C** – THREE

	<b>Wilson Hall</b>	<b>Skid more Hall</b>	<b>Agricultu re Hall</b>	<b>Canton Hall</b>
<b>Joseph</b>	<b>25.....</b>			<b>29.....</b>
<b>David</b>		One	<b>27.....</b>	Two
<b>Carrie</b>	Three	<b>26.....</b>	<b>28.....</b>	<b>30.....</b>

**Student Space:**



## Part 4

### Questions 31–33

- **Label the diagram.**
- **Write NO MORE THAN TWO WORDS AND/OR A NUMBER for each answer.**

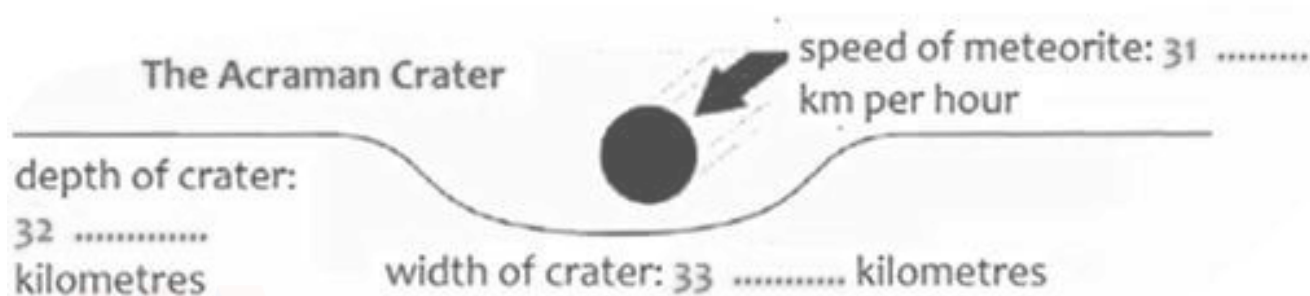

31. \_\_\_\_\_

32. \_\_\_\_\_

33. \_\_\_\_\_

### Questions 34–36

- **Choose from letters A–C.**

34. The crater at Acraman is

- A. nowadays entirely covered by sea water.
- B. one of the most beautiful on the earth.
- C. less spectacular than others in Australia.

35. Williams realized what had happened at Acraman when he

- A. saw pictures of the area taken from above.
- B. visited Acraman for the first time in 1980.
- C. noticed a picture of the crater in a textbook.

36. Where was rock from Acraman found ?

- A. Only in the Flinders mountains.
- B. At several places over 300 km from Acraman.
- C. At a place 500 km from Acraman, but nowhere else

#### Questions 37–40

- Write NO MORE THAN TWO WORDS for each answer.

37. What made the sea water shake ? .....

38. What threw the pebbles into the air ?.....

39. What was mixed with silt to form a layer of rock ?.....

40. What shaped the ripples on top of the rock ? .....

## Practice Test 8

### Instructions to follow

- Listen to the [audio](#) and answer the questions below.

### Part 1

#### Questions 1-4

- Complete the notes below.
- Write **ONE WORD AND/ OR A NUMBER** for each answer.

Student's name: Martin Hansen

Faculty of: 1 \_\_\_\_\_

Address: 2 \_\_\_\_\_ Avenue, Hesperian, Hayward

Telephone: 3 \_\_\_\_\_

Date of birth: 15th June, 1986

Nationality: 4 \_\_\_\_\_

#### Questions 5-10

- Circle the correct A - C.

5. Why is Martin visiting the doctor ?

- A. He gets blue in his eyes
- B. He feels sad
- C. He lacks friends

6. According to the doctor, what is the evidence of a psychiatric problem ?

- A. One think life is difficult
- B. One feels difficult in making friends
- C. One's daily life is disrupted

7. What causes Martin's depression ?

- A. Some worrying change in life
- B. Family history of depression
- C. Abuse of alcohol

8. Antidepressant medicines is not suggested by the doctor because

- A. They are not effective
- B. Martin's depression is not serious
- C. They have negative effects

9. The purpose of psychotherapy is

- A. To change patients' behaviors
- B. To make patients have an insight into life
- C. To help patients cope with feelings more effectively

**Questions 10**

- **Circle TWO letters A-E.**
- **Write an answer next to 10 on your answer sheet.**

**10.** What does the doctor suggest Martin should do ?

- A.** Have regular meals
- B.** Take exercises regularly
- C.** Participate in some leisure activities
- D.** try to handle the heavy load
- E.** Overcome the difficulties in life

**Student Space:**

IELTSMaterial.com



## Part 2

### Questions 11–14

- **Complete the summary.**
- **Write ONE WORD ONLY for each answer.**

### Bird Migration!

Birds migrate for two main reasons: to look for.....(11)..... and to breed. When they are breeding they need to move to areas where they can .....(12)..... young in the spring. They migrate from the (13)..... to cooler countries in the north. They spend several months there, flying south again in the winter to warmer (14).....

### Questions 15–17

- **Write NO MORE THAN TWO WORDS for each answer.**

15 . How has global warming affected the arrival of spring ? .....

16. Why have birds started to migrate earlier ? .....

17. What happens to the population of birds that breed late ? .....

**Questions 18–20**

- Choose **THREE** letters, **A–F**.

**Match each geographical area with a migration pattern.**

- A migration to warm countries.
- B clockwise migration.
- C long distance migration.
- D partial migration.
- E migration to countries with long days.
- F circular migration around entire globe.

**18.** The Tropics

-----

**19.** The Arctic and Antarctic

-----

**20.** North America

-----

**Student Space:**

## Part 3

### Questions 21–26

- Choose the correct letter A, B, or C.

21. What is Matthew considering a student work placement ?
- A. he was informed an interesting vacancy.
  - B. he needs some extra income.
  - C. he wants to try out a career option.
22. Which part of the application process did Linda find most interesting ?
- A. the psychometric test.
  - B. the group activity.
  - C. the individual task.
23. During her work placement, Linda helped find ways to
- A. speed up care assembly.
  - B. process waste materials.
  - C. calculate the cost of design faults.
24. Why did Linda find her work placement tiring ?
- A. she wasn't used to full-time work
  - B. the working hours were very long.
  - C. she felt she had to prove her worth.

25. What did Linda's employers give her formal feedback on ?

- A. engineering ability.
- B. organizational skills.
- C. team working.

26. What was the main benefit of Linda's work placement ?

- A. Improved academic skills.
- B. An offer of work.
- C. the opportunity to use new software.

### Questions 27-30

- Choose FOUR answers from the box and questions 27-30.
- Write the correct letter A-F.

What does Linda think about the books on Matthew's reading list ?

#### Opinions !

- A helpful illustrations
- B easy to understand
- C up-to-date
- D comprehensive
- E specialized
- F useful case studies

**Books !**

27. The Science of Materials \_ \_ \_ \_ \_
28. Materials Engineering \_ \_ \_ \_ \_
29. Engineering Basics \_ \_ \_ \_ \_
30. Evolution of Materials \_ \_ \_ \_ \_

**Student Space:**

## Part 4

### Questions 31–32

- Choose TWO letters, A–F.

Which two of the following problems are causing concern to educational authorities in the USA?

- A differences between rich and poor students
- B high numbers dropping out of education
- C falling standards of students
- D poor results compared with other nationalities
- E low scores of overseas students
- F differences between rural and urban students

31. \_\_\_\_\_

32. \_\_\_\_\_

**Questions 33–34**

- Choose TWO letters, A–F.

**According to the speaker, what are two advantages of reducing class sizes?**

- A** more employment for teachers
- B** improvement in general health of the population
- C** reduction in number of days taken off sick by teachers
- D** better use of existing buildings and resources
- E** better level of education of workforce
- F** availability of better qualified teachers

33. \_\_\_\_\_

34. \_\_\_\_\_

**Student Space:**

## Questions 35–40

- Complete the table below.
- Write ONE WORD OR A NUMBER for each answer.

## USA Research Project Into Class Size

State	Schools involved	Number of students participating	Key findings	Problems
Tennessee	about 70 schools	in total 35_____	significant benefit especially for 36_____ pupils	lack of agreement on implications of data
California	37_____ schools	1.8 million	very little benefit	shortage of 38_____, especially poorer areas, no proper method for 39_____ of project
Wisconsin	14 schools with pupils from 40_____ families		similar results to Tennessee project	



## Practice Test 9

### Instructions to follow

- Listen to the [audio](#) and answer the questions below.

### Part 1

#### Questions 1–5

- Choose the correct letter A, B or C.

1. The camping trip will be held

- A. the following month.
- B. from the 24th to the 26th
- C. over a five-day period.

2. Jamie's complaint about last year's trip that

- A. the camp wasn't big enough.
- B. he was unhappy while at the camp.
- C. he had problems finding the camp.

3. The campsite is located

- A. in the Lake District.
- B. in Carlisle.
- C. beside Lake Brant.

4. Jamie thinks the forests will be good for children who

- A. are used to nature.
- B. live in cities.
- C. like sports.

5. Each child will pay

- A. less than £4 a night.
- B. approximately £5.
- C. more than £10.

### Questions 6–10

- Complete the sentence below.
- Write ONE WORD ONLY for each answer.

- 6. After they arrive, the children will have a ..... at 8 o'clock.
- 7. On Saturday morning the children will get up at ..... .
- 8. During the 'talk back' session the children can ..... their day.
- 9. On Sunday the children will go on a day trip to visit the ..... .
- 10. At 6 o'clock on Sunday the children will be on the ..... .

## Part 2

### Questions 11–14

- **Complete the sentences below.**
- **Write NO MORE THAN TWO WORDS for each answer.**

11. Jasmine Climb founded her school on a quiet and isolated site because she appreciated the ..... and serenity of such places.

12. When the school was first found, it had neither trees nor a ..... .

13. The students listening to the speech will be staying at the school for ..... .

14. The program for the students' first day will culminate with a ..... .

**Student Space:**

 IELTSMaterial.com

## Questions 15–20

- Complete the plan below.
- Write **NO MORE THAN TWO WORDS** for each answer.

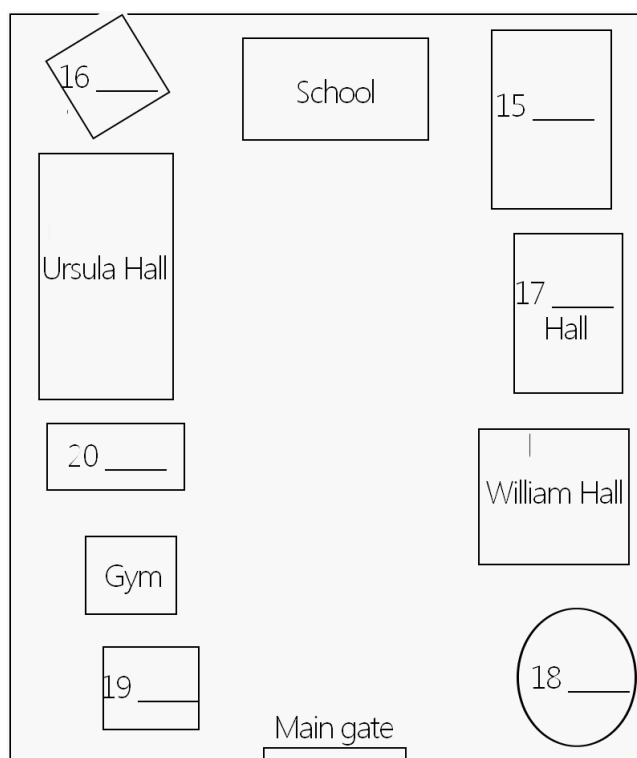

15. \_\_\_\_\_
16. \_\_\_\_\_
17. \_\_\_\_\_
18. \_\_\_\_\_
19. \_\_\_\_\_
20. \_\_\_\_\_

## Part 3

### Questions 21–25

- Complete the summary below.
- Write NO MORE THAN TWO WORDS for each answer.

### High Achievers

Although it is thought that people who bring work home every night would be top achievers, they tend to peak early and then go into **21**\_\_\_\_\_. High achievers work hard, but within **22**\_\_\_\_\_. It is also important to choose **23**\_\_\_\_\_ you enjoy. Top achievers spend over **24**\_\_\_\_\_ of their working hours doing work they prefer. They want **25**\_\_\_\_\_ not just external rewards.

### Questions 26–30

- Choose the correct letter A, B, or C.

**26.** Top achievers take risks

- A.** without worrying about the consequence
- B.** only if they are assured of success
- C.** even if they face possible failure

**27. Very often perfectionists**

- A.** turn out to be top achievers
- B.** don't get many results
- C.** are not hard working

**28. When top achievers make mistakes**

- A.** they ignore the fact
- B.** they get angry with themselves
- C.** they learn from the experience

**29. Top achievers tend to be people who**

- A.** work well with others
- B.** prefer to work alone
- C.** complicate matters

**30. Loners**

- A.** want to do everything themselves
- B.** are free of the compulsion to be perfect
- C.** take no notice of rivals

## Part 4

### Questions 31–37

- Answer the questions below.
- Write NO MORE THAN ONE WORD AND/OR A NUMBER.

31. How many English speakers are there around the world today?
32. Aside from French, which other language does the speaker say was more widely spoken than English in the 19th century?
33. Who does the speaker believe will determine the future of English?
34. What is the alternative name for English pidgin and creole languages?
35. What does “longi” mean?
36. According to the speaker, which language has a history which is very similar to English?
37. What kind of languages are Spanish, French, and Italian?

### Questions 38–40

- Choose the correct letters, A, B, or C.
- Write your answers in boxes 38–40 on your answer sheet.

38. The speaker says that Jamaican and South African English

- A. are very traditional languages.
- B. have greatly influenced the English language.
- C. were created very recently.

**39.** According to the second theory mentioned by the speaker, English

- A.** might lose some of its more complex features on a global level.
- B.** might become even more complicated than it is now.
- C.** might be called 'Globish'.

**40.** English is a unique language because

- A.** it has the largest number of speakers in the world.
- B.** it hasn't changed much throughout human history.
- C.** it's spoken by a larger number of non-natives than any other language.

**Student Space:**

 IELTSMaterial.com



## Practice Test 10

### Instructions to follow

- Listen to the [audio](#) and answer the questions below.

### Part 1

#### Questions 1–5

- Complete the details below.
- Write NO MORE THAN TWO WORDS AND/OR A NUMBER for each answer.

Card number: 6992 (1) \_\_\_\_\_ 11478921

Name: Carlos da Silva

Postcode: (2) \_\_\_\_\_

Address: (3) \_\_\_\_\_ Vauxhall Close, London

Date of birth: 13 July (4) \_\_\_\_\_

Mother's maiden name: (5) \_\_\_\_\_

## Questions 6–10

- Circle the correct letters, A–C.

6. The caller has paid

- A. less than the computer shows.
- B. more than the computer shows.
- C. £500 twice.

7. The caller is also worried about

- A. a bill that is too high.
- B. an overpayment to a restaurant.
- C. a payment that he does not recognize.

8. The interest

- A. went up in April.
- B. has not changed.
- C. has gone down.

9. The caller's number is

- A. 020 7997 9909.
- B. 020 7989 7182.
- C. 020 8979 7182.

**10.** The operator will ring the caller

- A.** Tomorrow.
- B.** in two hours.
- C.** very soon.

**Student Space:**



## Part 2

### Questions 11–17

- Complete the notes below.
- Write NO MORE THAN THREE WORDS AND/OR A NUMBER for each answer.

#### School Excursion Permission Note

Class: 3A

School excursion to: 11 \_\_\_\_\_

Bus will depart from: 12 \_\_\_\_\_ at: \_\_\_\_\_ 13 \_\_\_\_\_

Bus will return to: 14 \_\_\_\_\_ at: \_\_\_\_\_ 15 \_\_\_\_\_

Students must bring 16 \_\_\_\_\_

Clothing: Students need 17 \_\_\_\_\_

### Questions 18–20

- Complete the information below.
- Write NO MORE THAN THREE WORDS AND/OR A NUMBER for each answer.

18. When will the bus get to the Blue Mountains? \_\_\_\_\_

19. What special equipment is on the bus? \_\_\_\_\_

20. What other class is going on the excursion? \_\_\_\_\_

## Part 3

### Questions 21–26

- Choose FIVE answers from the box, and write the correct letter, A–H, next to questions 21–26.

What is the tutor's opinion of the following company projects?

#### Tutor's opinion

- A It would be very rewarding for the student.
- B It is too ambitious.
- C It would be difficult to evaluate.
- D It wouldn't be sufficiently challenging.
- E It would involve extra costs.
- F It is beyond the student's current ability.
- G It is already being done by another student.
- H It would probably have the greatest impact on the company.

#### Company projects

- 21. Customer database \_ \_ \_ \_ \_
- 22. Online sales catalogue \_ \_ \_ \_ \_
- 23. Payroll \_ \_ \_ \_ \_
- 24. Stock inventory \_ \_ \_ \_ \_
- 25. Internal security \_ \_ \_ \_ \_
- 26. Customer services \_ \_ \_ \_ \_

**Questions 27–28**

- Choose TWO letters, A–E.

**Which TWO problems do Sam and the tutor identify concerning group assignments?**

- A** Personal relationships.
- B** Cultural differences.
- C** Division of labour.
- D** Group leadership.
- E** Group size.

27. \_\_\_\_\_

28. \_\_\_\_\_

**Questions 29–30**

- Choose TWO letters, A–E.

**Which TWO problems does Sam identify concerning the lecturers?**

- A** Punctuality.
- B** Organization.
- C** Accessibility.
- D** Helpfulness.
- E** Teaching materials.

29. \_\_\_\_\_

30. \_\_\_\_\_

**Student Space:**

## Part 4

### Questions 31–35

- Write **ONE WORD ONLY** for each answer.
- Fill in the gaps numbered **31–35** in the notes below.

A Vice – president Finance to (31)\_\_\_\_\_ the spending of the Union's grant to ensure that all areas of Students Union activity run smoothly without any financial (32)\_\_\_\_\_. There are (33)\_\_\_\_\_ members on the finance team. We are all here to help you as (34)\_\_\_\_\_ as we can. Although I administer the Union's finances, in the end, it is you who have the (35)\_\_\_\_\_ say in expend.

### Questions 36–40

- Indicate whether the following statements are true or not by writing

- A** for a statement which is true.
- B** for a statement which is false.
- C** if there is insufficient information.

**36.** The speech is a vice – president's introduction.

**37.** The speech is an election speech.



38. The vice – president is increasing the number of hours that the Finance Office is open.
39. The student Union is an organization run by the college.
40. The president is a third – years student at Earling college.

**Student Space:**



## Practice Test 11

### Instructions to follow

- Listen to the [audio](#) and answer the questions below.

### Part 1

#### Questions 1–5

- Complete the notes below.
- Write NO MORE THAN ONE WORD OR A NUMBER.

### Library application form

Surname:	Price
First name:	Angela Mary
Address:	apartment 3, 86 (1) _____ street, Pimlico
Post code:	(2) _____
Telephone:	8763 5142 home
(3) _____	work
Driver's license number:	(4) _____
Date of birth: Day: 24 Month:	(5) _____
Year:	1981

**Questions 6–8**

- **Circle the THREE Letters A– F.**

**What type of books does Angela like?**

- A** sport
- B** travel
- C** classics
- D** history
- E** cooking
- F** nature

6. \_\_\_\_\_

7. \_\_\_\_\_

8. \_\_\_\_\_

**Questions 9–10**

- **Write NO MORE THAN THREE WORD OR A NUMBER.**

**9.** How much does it cost to join the library?

**10.** When will Angela's card be ready?

## Part 2

### Questions 11–13

- Choose the correct letter A , B or C.

11. Who provides the money to run the park ?

- A. the owners
- B. the government
- C. the visitors

12. When did the park move to the public open space ?

- A. 1987
- B. 2000
- C. 2003

13. How much do primary school children pay ?

- A. \$23.00
- B. \$10.00
- C. \$16.00

### Questions 14–15

- Write True or False.

14. Once you pay the entry fee, there are no extra costs. \_ \_ \_ \_

15. The park is open every day of the year. \_ \_ \_ \_

### Questions 16–18

- Complete the table below.
- Write NO MORE THAN ONE WORD OR A NUMBER.

Animal	Viewing Time	Special Features
Koalas	10.00 am to 4.30 pm	view koalas in natural <b>16</b> .....
Kangaroos	9.00 am to 5.30 pm	walk through kangaroos <b>17</b> .....
Wombats	11.00 am, 2.00 pm & <b>18</b> .....	join in the interactive show

**Questions 19–20**

- Choose TWO letters A–E.

**Which TWO other attractions are also mentioned ?**

- A** farmyard
- B** children's show
- C** working farm
- D** country show
- E** volunteer program

19. \_\_\_\_\_

20. \_\_\_\_\_

**Student Space:**

## Part 3

### Questions 21–24

- Answer the questions below.
- Write **NO MORE THAN THREE WORDS** for each answer.

21. What aspect of history is it important to learn something from?
22. What do we also need to know about our ancestors?
23. Where are transferable skills useful?
24. What kind of approach to learning does social science use?

### Questions 25–30

- Choose your answers from the list below and write the letters A–H next to questions 25–30..

**What is said about each of these subjects studied on a social studies course?**

- A** This will focus on how each generation learns about its own culture
- B** This necessarily includes a study of physics and chemistry
- C** This is studied from the point of view of human behavior
- D** This will only be covered in terms of its theory
- E** This also covers the distribution of wealth
- F** This includes the study of archaeology
- G** This has received criticism for not being scientific enough
- H** This includes some work on urban planning

- 25. Anthropology
- 26. Economics
- 27. Education
- 28. Geography
- 29. Law
- 30. Sociology and social work

**Student Space:**





## Part 4

### Question 31 – 40

- Complete the table below.
- Write ONE WORD ONLY for each question.

Questionnaire	John	Mary
Countries interested	Spain, Italy, or 31_____	China or 32_____&&
Language studied	34_____	China because it is really interesting country with long 33_____
Family roots	35_____	

### Question 36 – 40

- Complete the notes below.
- Write NO MORE THAN ONE WORD for each answer.

36. What is the main reason that John wants to go to Japan?

-----

37. What is the major drawback for John about going to Japan?

Can't speak -----

38. Why does John want to only study abroad for a semester?

Graduate on -----

39. What country is Mary's first choice?

-----

40. What two countries does John prefer to go to?

Japan and -----

**Student Space:**



## Practice Test 12

### Instructions to follow

- Listen to the [audio](#) and answer the questions below.

### Part 1

#### Questions 1–3

- Choose the correct letter from A–C.

1. What are they looking for?

- A. Books & newspaper
- B. Bert's Cafe
- C. France Air Check-in

2. Who do they ask for directions?

- A. Men in uniform
- B. Men with trolley
- C. Men with hat

3. What does George want to buy before he catches the plane?

- A. Tea
- B. Coffee
- C. Soda

**Questions 4–10**

- Complete the notes below.
- Write NO MORE THAN TWO WORDS AND/OR A NUMBER for each answer.

**Excess Baggage Declaration Certificate**

Amount Paid: (4).....

Given Name: George

Family Name: (5).....

Nationality: (6).....

Flight Number: (7).....

Contact Number: (8).....

What is the box? University (9).....

Some clothes and computer (10).....

**Student Space:**

## Part 2

### Questions 11–16

- Complete the table below.
- Write ONE WORD ONLY for each answer.

	Good Points About Him	Bad Points About Him
<b>Behavior</b>	He is <b>11</b> .....	He is <b>12</b> .....
<b>His Friends</b>	His friends visit <b>13</b> .....	They <b>14</b> .....
<b>Other</b>	He pays rent <b>15</b> .....	He doesn't <b>16</b> .....

### Questions 17–20

- Complete the notes below.
- Write NO MORE THAN TWO WORDS for each answer.

### Issues to Discuss

Communication: **17**.....

Friends: **18** .....

Cigarettes: **19** .....

Cleaning: must **20** .....

## Part 3

### Questions 21–25

- Complete the notes below.
- Write **NO MORE THAN TWO WORDS** for each answer.

### Lectures and Note Taking

Complete all background **21**..... before the lecture.

Think about **22**..... of lecture.

Take notes during lectures.

Edit **23**..... immediately after lecture.

Revise before **24**.....

Revise every **25**.....

### Questions 26–29

- Complete the information below.
- Write **ONE WORD ONLY** for each answer.

**26.** Where should you sit when you attend a lecture?

.....

**27.** What should you do if you miss an important point?

.....

28. Why must your notes be easy to read?

.....

29. What do we call expressions which indicate what is coming next?

.....

### Questions 30

- Choose the correct letter, A, B or C.

30. Where does Carlos write summing up points on his notes?

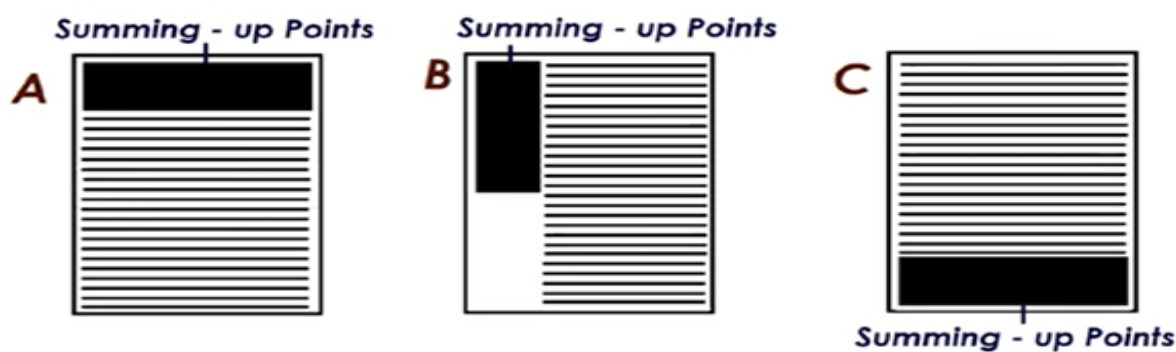

**Student Space:**

## Part 4

### Questions 31–40

- Complete the notes below.
- Write **NO MORE THAN TWO WORDS OR/A NUMBER** for each answer.

### Traditional Samoan Houses

#### Overall Design

- House: round or **31**..... shaped.
- No walls
- Several **32**..... : to shelter occupants from wind and rain.
- Floor: river **33**..... to control temperature.

#### Roof

- dome-shaped and thatched using **34**..... cane leaves.
- Steep sides prevent **35**.....
- High too permits **36**..... loss

#### Supporting Posts

- made using work from the **37**..... around the village
- used to show **38**..... of chiefs and speakers at meeting
- attached using rope made by the old **39**..... in the village
- rope pulled tightly to form a complex **40**..... around the village



## Answer Keys

### Listening Test 1

Part 1		Part 2	
Question	Answer	Question	Answer
1	Durham	11	B
2	7848762	12	A
3	trader	13	C
4	17 brown	14	C
5	4065	15	B
6	6 months	16	C
7	washing machine	17	E
8	750	18	02075624028
9	water	19	27.50
10	noisy	20	3 hours

Part 3		Part 4	
Question	Answer	Question	Answer

21	M	31	Select
22	I	32	Invest
23	B	33	Research
24	P	34	Sell
25	Statistics	35	Buy
26	Course	36	Calculate
27	Scanning	37	29
28	Exercises	38	Manufacturing
29	B	39	Import Prices
30	C	40	February 5th

## Listening Test 2

Part 1		Part 2	
Question	Answer	Question	Answer
1	terminal	11	£85
2	Pantera	12	3 a month
3	East	13	Thrillers
4	07765328411	14	Comedy programmes
5	hotel (restaurant)	15	Parts

6	raincoat	16	Record
7	(walking) shoes	17	£ 71.99
8	mountain lives	18	Labour
9	Chocolate(s)	19	CDs
10	Calendar	20	Insurance

Part 3		Part 4	
Question	Answer	Question	Answer
21	Drums classical	31	B
22	Guitar classical	32	B
23	Drums rock	33	A
24	Violin country	34	Microclimate
25	Piano opera	35	Concentration
26	Flute jazz	36	Frost
27	Heart/ heartbeat	37	Liquid
28	Blood pressure/heartbeat	38	Supercooling
29	melodious	39	Mars

30	Cultures	40	Locations
----	----------	----	-----------

### Listening Test 3

Part 1		Part 2	
Question	Answer	Question	Answer
1	Classical	11	C
2	Jonathan	12	B
3	January 21 <sup>st</sup>	13	A
4	Island	14	A
5	1	15	Gardening art
6	Queen	16	Pear
7	02046751222	17	Watermill
8	Tutor	18	Refreshments
9	Mother	19	River cotton
10	1000	20	strawberries

Part 3		Part 4	
Question	Answer	Question	Answer
21	London museum	31	C

22	Telephone interviews	32	A
23	90 people	33	A
24	Ceramic	34	B
25	Peru	35	C
26	Surface	36	A
27	Local clay	37	A
28	Dried	38	B
29	Sorting	39	B
30	The rich people	40	D

### Listening Test 4

Part 1		Part 2	
Question	Answer	Question	Answer
1	Douglas	11	B
2	Hill Avenue	12	A
3	765482	13	C
4	Low volume	14	A
5	Power cut	15	C

6	Schneider SVV5002	16	B
7	7 years	17	F
8	B	18	C
9	C	19	E
10	A	20	A

Part 3		Part 4	
Question	Answer	Question	Answer
21	Last 40	31	Carbon
22	Sea gem	32	Forests
23	Economic crisis	33	Transport
24	Leases	34	Rubbish
25	Global price	35	Promotion
26	Mature province	36	Culture
27	Fire extinguishers	37	Crime
28	Lifeboat stations	38	Air
29	Mock fire	39	Welfare
30	Building site	40	Traffic

## Listening Test 5

Part 1		Part 2	
Question	Answer	Question	Answer
1	95 Green lane	11	10
2	07779724868	12	(straightforward) walking
3	WIL 948578269	13	Rock climbing
4	Four/4	14	Gave up
5	Toyota	15	2
6	£170	16	School
7	The international hotel	17	8
8	Breakdown + an accident	18	2
9	E	19	Exclusive
10	J	20	Large

Part 3		Part 4	
Question	Answer	Question	Answer
21	B	31	Dead
22	C	32	Stock
23	E	33	Feel comfortable
24	Organize questions	34	Dwell
25	Conduct	35	Strongest offers
26	3rd April	36	D
27	15/20	37	A
28	Eye contact	38	B
29	Visual aids	39	C
30	Whiteboard	40	E



## Listening Test 6

Part 1		Part 2	
Question	Answer	Question	Answer
1	Supervisor	11	Community week
2	Regularly	12	Give up
3	List	13	Responsible
4	Communicate	14	Practical
5	Objections	15	Mr. Tyler
6	Concern	16	Street
7	A	17	Kitchen
8	C	18	B
9	E	19	A
10	G	20	C

Part 3		Part 4	
Question	Answer	Question	Answer
21	Mitchell	31	1960s
22	Battery	32	Battery

23	Education	33	1980
24	994578ED	34	Academic
25	C	35	10,000
26	B	36	A review
27	B	37	Test Centers
28	A	38	Speaking
29	C	39	2005
30	A	40	Highly competitive

### Listening Test 7

Part 1		Part 2	
Question	Answer	Question	Answer
1	Dover	11	D
2	634085354	12	E
3	C	13	C
4	C	14	A
5	£45	15	6%
6	Recovery fees	16	Drive
7	Optional services	17	Growth

8	Thursday	18	Deposited
9	M9021	19	Dark
10	Street maps	20	Brown

Part 3		Part 4	
Question	Answer	Question	Answer
21	CCT	31	90,000
22	CH	32	4 km / Kilometers
23	CO	33	40 km /kilometers
24	CH	34	C
25	C	35	A
26	A	36	B
27	B	37	The Earthquake / Shock waves
28	B	38	The Explosion
29	C	39	Sand
30	A	40	Huge waves

## Listening Test 8

Part 1		Part 2	
Question	Answer	Question	Answer
1	electronics	11	food
2	2805	12	feed
3	73424655	13	tropics
4	Sydney	14	climates
5	B	15	comes earlier
6	C	16	higher temperatures
7	A	17	drops drastically
8	C	18	D
9	C	19	F
10	B,C	20	B

Part 3		Part 4	
Question	Answer	Question	Answer
21	A	31	A
22	B	32	D

23	A	33	B
24	C	34	E
25	B	35	12000
26	B	36	minority
27	B	37	all
28	A	38	Teachers
29	D	39	evaluation
30	C	40	poor

### Listening Test 9

Part 1		Part 2	
Question	Answer	Question	Answer
1	A	11	Beauty
2	A	12	Main gate
3	C	13	Ten weeks
4	B	14	Film night
5	A	15	Main hall
6	barbecue	16	Garden office

7	seven	17	Peter
8	discuss	18	Pavilion
9	caves	19	Canteen
10	buses	20	Study centre

Part 3		Part 4	
Question	Answer	Question	Answer
21	Decline	31	2.1
22	Strict limits	32	German
23	A career	33	Non-native
24	Two-thirds	34	Englishes
25	Internal satisfaction	35	Trousers
26	C	36	Latin
27	B	37	Romance
28	C	38	B
29	A	39	A
30	A	40	C

## Listening Test 10

Part 1		Part 2	
Question	Answer	Question	Answer
1	3443	11	The Blue Mountains
2	SE1 8PB	12	The front gate
3	43	13	8 am
4	1963	14	The sea gate
5	Moore	15	6 pm
6	B	16	Their own lunch
7	C	17	Strong shoes
8	C	18	11 am
9	B	19	First aid kit
10	C	20	3b

Part 3		Part 4	
Question	Answer	Question	Answer
21	D	31	Oversee
22	B	32	Headaches

23	A	33	Four
24	H	34	Best
25	F	35	Final
26	E	36	A
27	B	37	B
28	E	38	C
29	A	39	C
30	C	40	C

## Listening Test 11

Part 1		Part 2	
Question	Answer	Question	Answer
1	Bridge	11	C
2	2065	12	C
3	84561307	13	B
4	4040AC	14	T
5	March	15	F
6	B	16	Environment
7	E	17	Enclosure
8	F	18	3:45 PM



9	\$20	19	A
10	Next week	20	C

Part 3		Part 4	
Question	Answer	Question	Answer
21	our past mistakes	31	Japan
22	What they thought	32	Germany
23	In a job	33	History
24	Flexible and adapter	34	Spanish
25	F	35	Italian
26	C	36	Girlfriend
27	A	37	Japanese
28	H	38	Time
29	E	39	China
30	G	40	Spain

## Listening Test 12

Part 1		Part 2	
Question	Answer	Question	Answer
1	C	11	quiet
2	A	12	impolite
3	B	13	rarely
4	\$40	14	smoke
5	laviloiers	15	promptly
6	Swiss	16	cooperate
7	FA 492	17	attend meeting
8	33198614537	18	follow rules
9	textbooks	19	strictly forbidden
10	disks	20	be done

Part 3		Part 4	
Question	Answer	Question	Answer
21	reading	31	oval
22	content	32	blinds
23	edit (notes)	33	stones

24	next lecture	34	sugar
25	week	35	dampness
26	front	36	heat
27	leave a space	37	forests
28	it saves time	38	status
29	signpost words	39	people
30	B	40	pattern



## If you score...

- **0 – 12**

you are highly unlikely to get you may get an acceptable an acceptable score under I score under examination conditions and we recommend that you spend a lot of time improving I more practice or lessons your English before you take IELTS

- **13–26**

you may get an acceptable score under examination conditions but we recommend that you think about having more practice or lessons before you take IELTS.

- **27–40**

you are likely to get an acceptable score under examination conditions but remember that different institutions will find different scores acceptable.



**GetGIS.ORG**  
Global Immigration Services



**Fulfilling Dreams Beyond Boundaries!**

**Now meet IELTS and Immigration experts at one place**



**Scan the QR code to book a Free consultation with our PR experts**

**Since you have purchased this Book, you can avail an Extra Discount when you opt for our PR services**



**IELTSMaterial.com**

**Helpline Number: +91 8929053019**

**Pride Hulkul 6th floor no 116  
Lalbagh Road, Bangalore,  
Karnataka 560027**